

SpectrumVoIP™

How to Assemble A Yealink Phone



Overview

This guide will go over how to assemble a new Yealink desk phone.

Attach The Stand

The stand piece can attach to the back of the Yealink phone to allow the phone to be placed at an angle on a desk. Insert the back of the phone at your desired angle level.

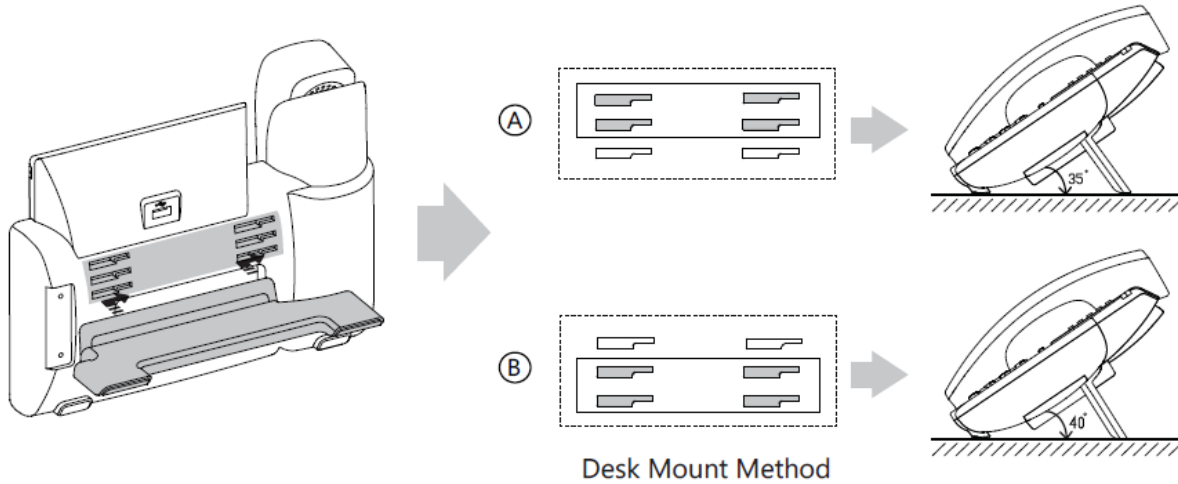

Plug in Handset

Next, plug the short side of the handset cable into the handset. The longer side should be plugged into the handset port on the back of the phone that is marked with a phone handset icon.

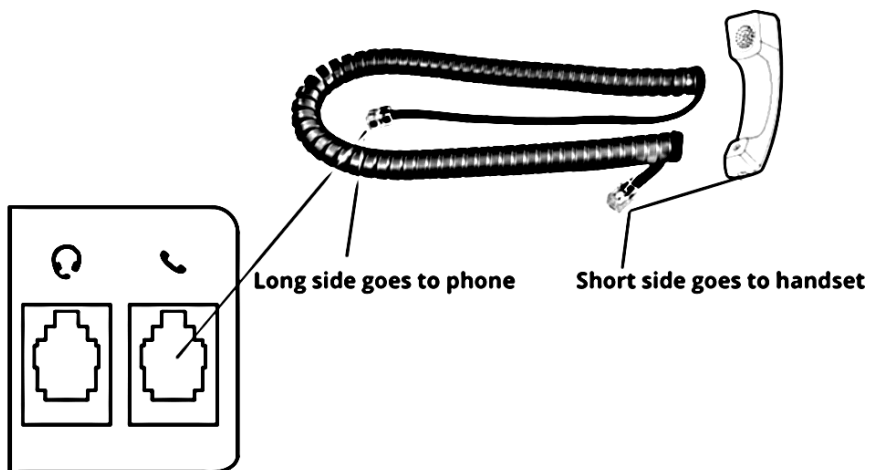

Also be sure to route the cable neatly behind the phone, inserting the cable behind the cable management tabs.



Connect Network and Power

You have two options for power and network connections. Your system administrator will advise you which one to use.

1. AC power (Optional) – Requires a Power Adapter (DC 5V)
2. Power over Ethernet (PoE) – Requires a PoE Switch or equivalent

Connect AC Power

1. Connect the of the power adapter into an electrical power outlet.
2. Connect the included or a standard Ethernet cable between the Internet port on the phone and the one on the wall or switch/hub device port

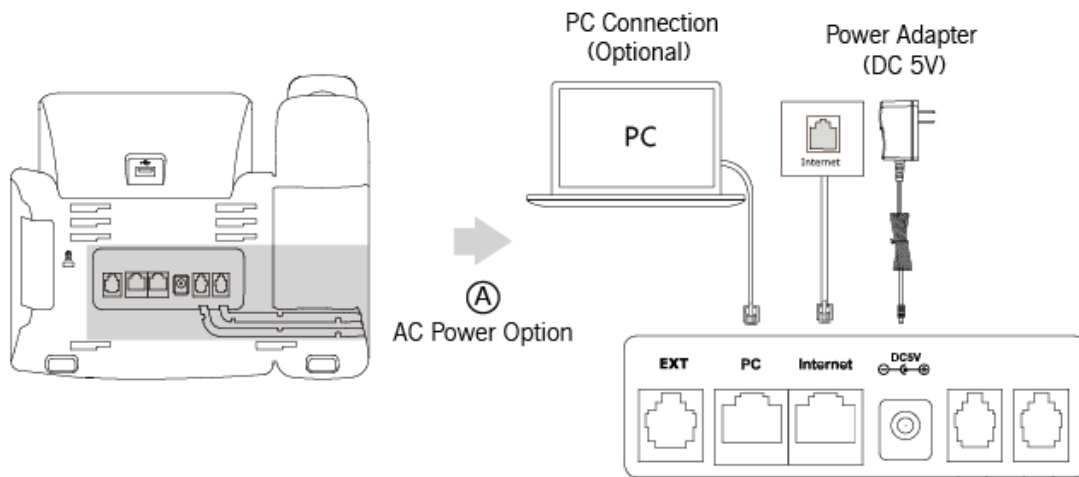

Power over Ethernet

With the included or a regular Ethernet cable, the Yealink phone can be powered from a PoE-compliant switch or hub.

To connect the PoE:

Connect the Ethernet cable between the Internet port on the phone and an available port on the in-line power switch/hub.



If in-line power is provided, you don't need to connect the phone to the power adapter. Make sure the switch/hub is PoE-compliant.

The phone can also share the network with another network device such as a PC (personal computer). This is an optional connection. We recommend that you use the Ethernet cable provided by Yealink.

Important! Do not remove power from the phone while it is updating firmware and configurations.